



Product Type: IP67 connector

Product Name:ESF-PS150A35B

Product Description:

Product Size

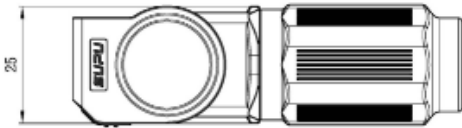
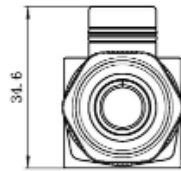
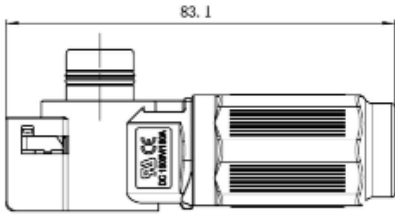

插头除键槽及类型标识不同外，其它结构均相同

订货号	物料名称	插头键槽	coding	备注
ESF-PS150A35Y	ESF-PS150A35Y 插头		无	橙色
ESF-PS150A35B	ESF-PS150A35B 插头			黑色
ESF-PS150A35Y-A	ESF-PS150A35Y-A 插头		A:20°	橙色
ESF-PS150A35B-A	ESF-PS150A35B-A 插头			黑色
ESF-PS150A35Y-B	ESF-PS150A35Y-B 插头		B:30°	橙色
ESF-PS150A35B-B	ESF-PS150A35B-B 插头			黑色

Parameters

☞ SUPU ID

ESF-PS150A35B

☞ Number of connections

1

☞ Connection method

Crimp

☞ Protection Level

IP67

☞ Operating temperature range	-40°C~125°C
☞ Insulation material	PA
☞ Insulation material group	III
☞ Contact material	Copper alloy
☞ Contact plating	Ag,Plated
☞ Insertion/withdrawal cycles	100
☞ Insertion force	≤75N
☞ Withdrawal force	≥10N

Technical data

☞ IEC Rated Current	150A
☞ IEC Rated Voltage	1500V
☞ Overvoltage category	III
☞ Degree of pollution	3
☞ Rated impulse voltage	12.3KV
☞ UL Rated Current	35mm ² (AWG2)
☞ UL Rated Voltage	Negative
☞ Stripping length	20mm±1mm
☞ Rated cross section	35mm ² (AWG2)
☞ Rated cross section(AWG)	35mm ² (AWG2)
☞ External cable diameter	9.5mm~12mm

Commercial data

☞ Order No	ESF-PS150A35B
------------	---------------

☞ Packing unit	1
☞ Minimum order quantity	PCS
☞ Weight per unit (without packaging)	0.062KG
☞ Single piece weight	0.060KG

Ningbo SUPU Electronics Co., Ltd.

Address: No. 150, Xinxing 4th Road, High-tech Industrial Development Zone,
Cixi City, Zhejiang Province, China

Zip code: 315303

Switchboard: +86 574-63288158

Fax: +86 574-63288170

E-mail:supucontact@supu.cn

Service Hotline: 400-626-6336



Wechat